

BURR ST.

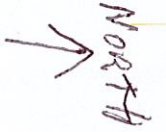

House 4.12 North Burr.

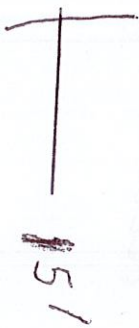

Alley

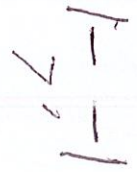
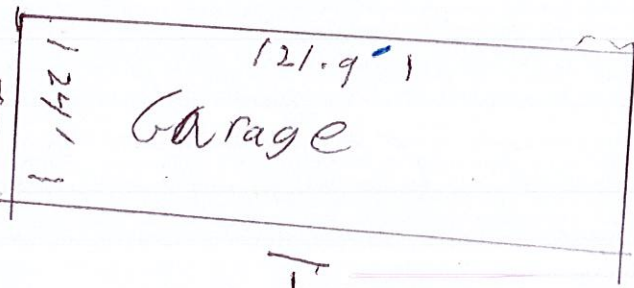

My Garage was burned in a fire. It has been here for over forty years with out an issue. I would like to build it with the same dimensions as it stood.

Property Line

To rebuild it I need a 3 foot variance from the alley to main door. ~~16~~ 13 foot instead of 16 foot otherwise I can not fit a car in the garage.