

\$18,000 = Feb 19

GENERAL NOTES

- 1. ALL NEW CONSTRUCTION SHALL COMPLY WITH LOCAL GOVERNING CODES AND PERFORMED BY LICENSED CONTRACTORS
- 2. ALL NEW CONSTRUCTION IN KITCHEN AREA SHALL COMPLY WITH STATE FOOD SERVICE LICENSING REQUIREMENTS
- 3. EXISTING RESTROOMS SHALL BE CONVERTED TO HANDICAP ACCESSIBLE RESTROOMS
- 4. NEW KITCHEN HOOD SHALL BE DESIGNED AND INSTALLED IN ACCORDANCE TO FIRE CODE AND HEALTH DEPARTMENT REQUIREMENTS. OWNER SHALL SUBMIT SHOP DRAWINGS TO ALL AGENCIES REQUIRING APPROVAL OF KITCHEN HOOD FIRE SUPPRESSION SYSTEM DESCRIBING HOOD DETAILS.
- 5. ALL NEW METAL FINISHES SHALL COMPLY WITH HEALTH DEPARTMENT REQUIREMENTS FOR CHAIRS, COUNTERTOP SURFACES AT FOOD PREPARATION AREAS
- 6. ALL EXISTING ELECTRICAL CONDITIONS SHALL BE VERIFIED BY ELECTRICAL CONTRACTOR AND PROVIDE NEW ELECTRICAL WORK AS REQUIRED TO COMPLY WITH CODE AND EQUIPMENT PROVIDED BY OWNER.

① = Fire hood vent? Fire wrap

② = Grease trap? Gallon Jan. V.?

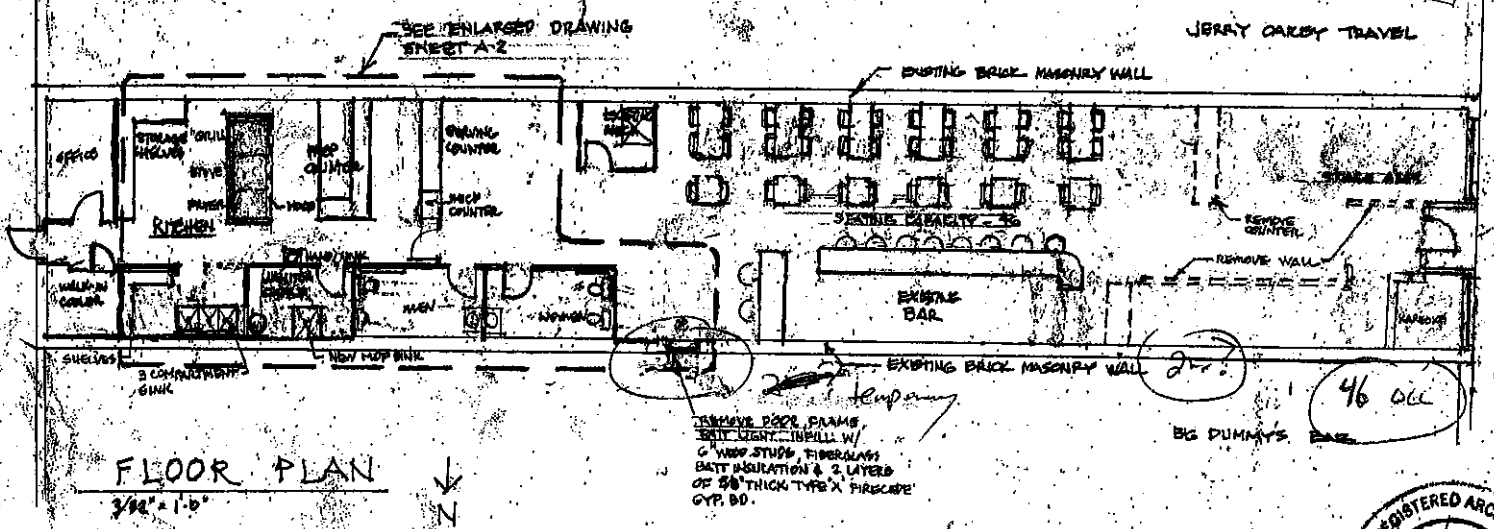

Plumb = mitchell Plumbing
 HWAC = Tressness
 Bldr. =



GENERAL NOTES:

1. REMOVE EXISTING LAY-IN CEILING TILE WITH CLEANABLE / REMOVABLE CEILING TILE AS REQUIRED BY DEPT. OF HEALTH IN FOOD PREP AREA.
2. ALL EXISTING EXPOSED WOOD STUD WALL FRAMED SHALL BE ENCLOSED WITH FINISHED 1/2" GYP. BOARD PAINTED OR FINISHED WITH REINFORCED FIBERGLASS WALL PANELS.
3. REMOVE EXISTING PLUMBING FIXTURES AND REPLACE WITH FIXTURES THAT COMPLY WITH ADA REQUIREMENTS. BACK FLUSH WALLS WITH WATERING FINISH MATERIAL, CAP ALL PLUMBING LINES ABANDONED AS REQUIRED BY EXISTING CODE.
4. NEW EXHAUST HOOD SHALL BE DESIGNED AND INSTALLED BY MECHANICAL CONTRACTOR AND COMPLY WITH EXISTING CODE. MECHANICAL CODE REQUIREMENTS AND HEALTH DEPARTMENT REQUIREMENTS FOR THE SUPPRESSION SYSTEM SHIP DRAWINGS SHALL BE SUBMITTED TO LOCAL BUILDING OFFICIAL FOR APPROVAL AND PERMIT.

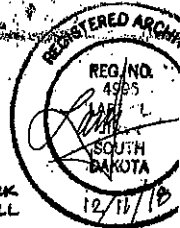

EXISTING BRICK MASONRY WALL

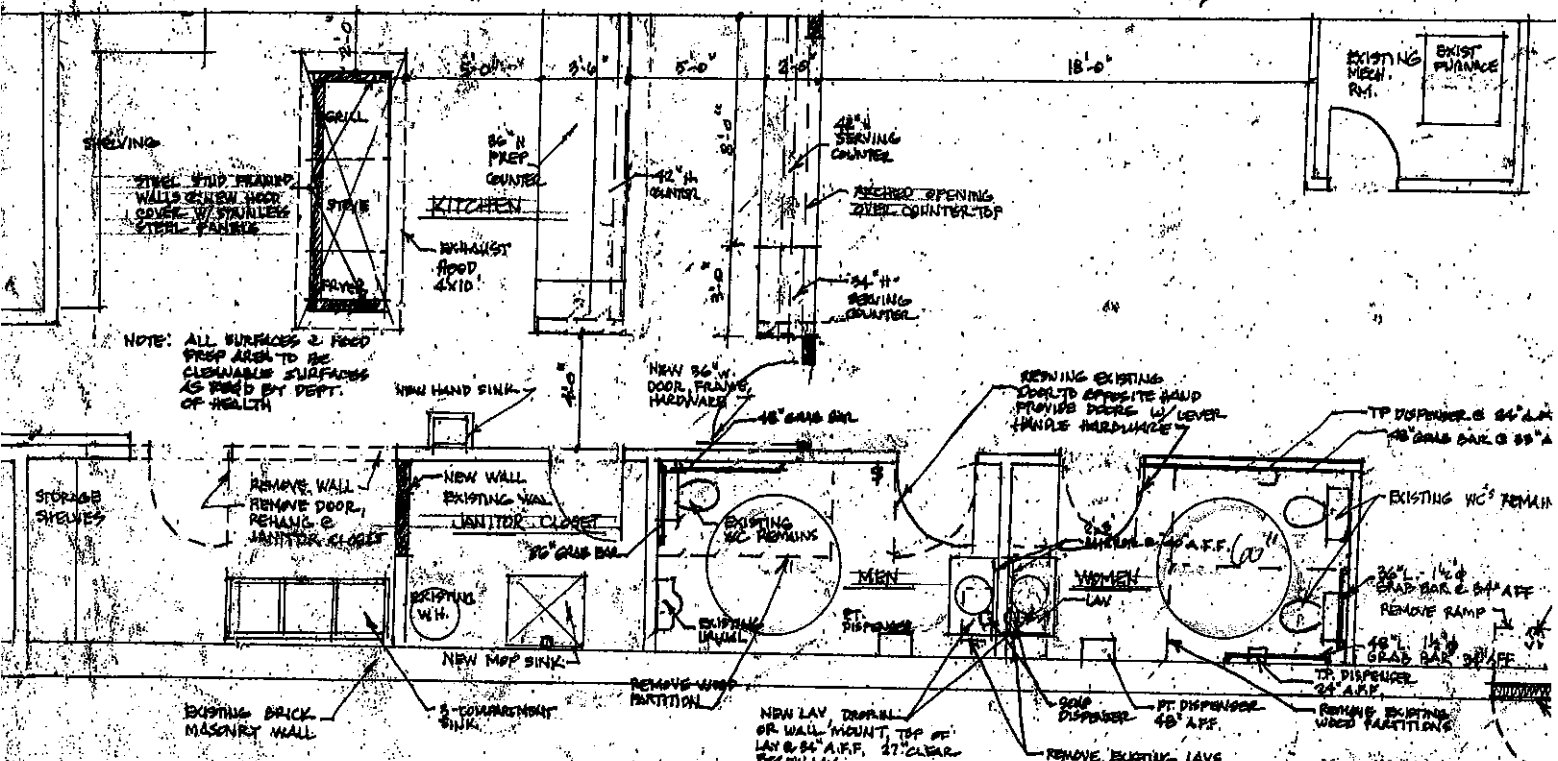

NOTE: ALL SURFACES & FOOD PREP AREA TO BE CLEANABLE SURFACES AS REQUIRED BY DEPT. OF HEALTH

KITCHEN PLAN

1/4" = 1'-0"

REMOVE ALUM. DOOR, FILL W/ SHELL DRYING WITH 2 HR. RATED CONSTRUCTION, 2\"/>